



ENNISMORE GARDENS

KNIGHTSBRIDGE SW7



A TWO BEDROOM, TWO BATHROOM APARTMENT SITUATED ON THE THIRD FLOOR OF THIS ELEGANT WHITE STUCCO FRONTED BUILDING, OVERLOOKING THE MOST SOUGHT-AFTER GARDEN SQUARE IN KNIGHTSBRIDGE.



Ennismore Gardens is a short walk away from Hyde Park and Harrods, the Brompton Road and all the internationally renowned shops, restaurants and amenities that the area has to offer.

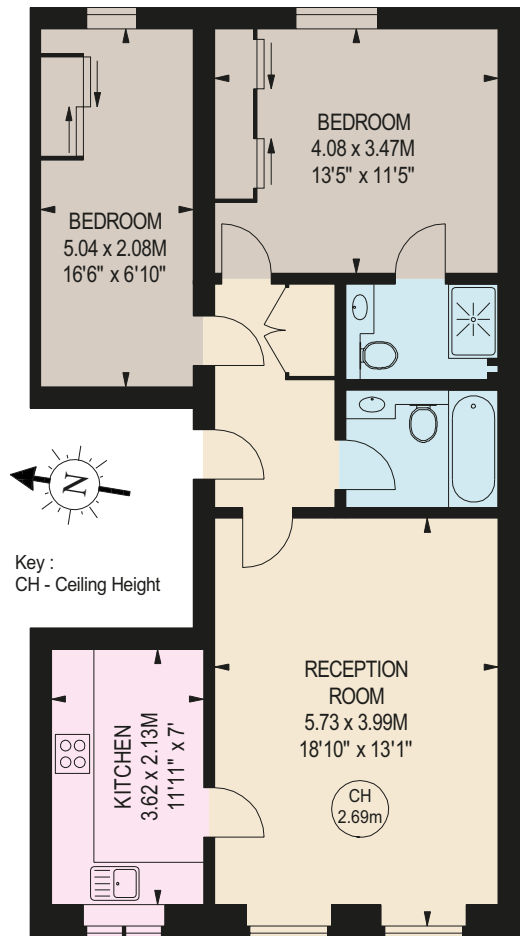

THIRD FLOOR

Approximate Gross Internal Area **70.79 sq m / 762 sq ft**

The floor plan is not to scale and measurements and areas shown are approximate and therefore should be used for illustrative purposes only

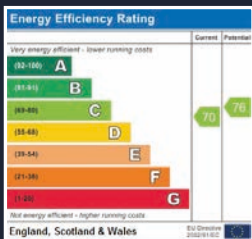

ACCOMMODATION AND AMENITIES

- Principal Bedroom with Ensuite Shower Room
- Second Bedroom
- Bathroom
- Reception Room
- Kitchen

TERMS

Price: £1,295,000
Share of Freehold with 980 years
Service Charges: All service charges, maintenance, insurance and ground rent amounts to £3,874 per annum



6-8 MONTELIER STREET,
LONDON SW7 1EZ
SALES | +44 (0)20 7581 8277
LETTINGS | +44 (0)20 7590 1200
info@nicolasvanpatrick.com
www.nicolasvanpatrick.com