

# RUTLAND GATE

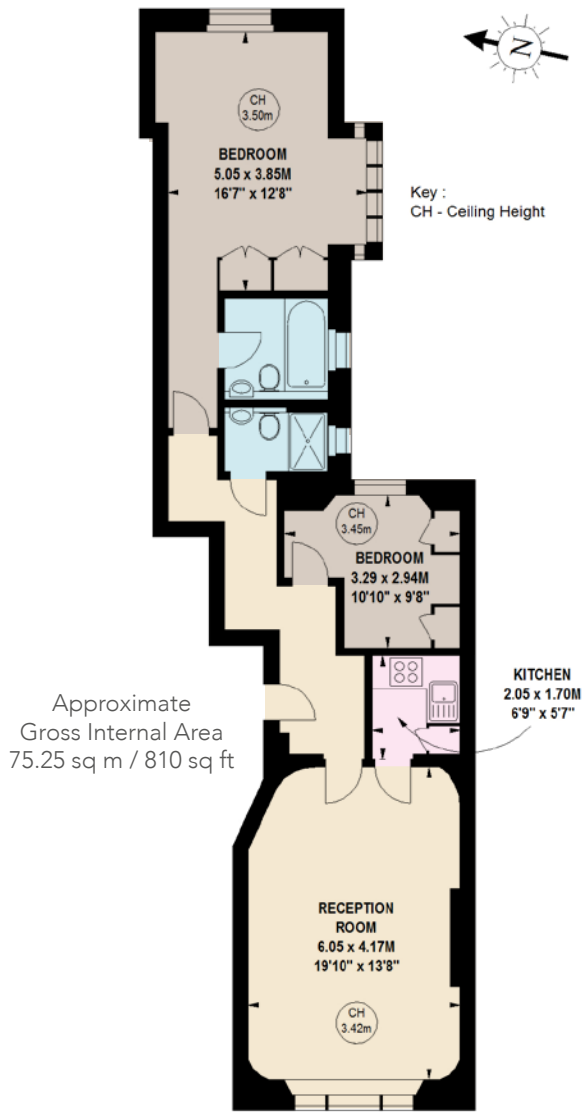

KNIGHTSBRIDGE SW7



Approximate  
Gross Internal Area  
75.25 sq m / 810 sq ft

**GROUND FLOOR**

**FEATURES**

- Share of Freehold with 84 Years Remaining
- Principal Bedroom with Ensuite Bathroom
- Second Double Bedroom • Shower Room
- Fully Fitted Kitchen • Reception Room

SITUATED IN THIS SOUGHT  
AFTER GARDEN SQUARE  
A BEAUTIFUL AND  
WELL-PROPORTIONED  
RAISED GROUND FLOOR  
APARTMENT WITH HIGH  
CEILINGS THROUGHOUT.

The property consists of a principal bedroom with ensuite bathroom, second double bedroom, shower room, reception room and a fully fitted kitchen. The flat is light and spacious and benefits from wooden floors in the reception room. Rutland Gate is a quiet street in the heart of Knightsbridge and within walking distance of Hyde Park.



Price: £1,595,000  
Tenure: Share of Freehold with 84 Years Remaining  
Service Charge: Approx £7,600 per annum

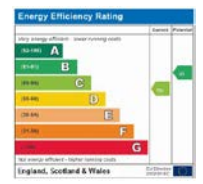

onTheMarket.com  
These details have been prepared for general guidance only and should not be relied upon by prospective purchaser/ tenants who before proceeding must check and otherwise satisfy themselves as to the property and the nature, state and availability of any facility or service.

6-8 MONTPELIER STREET,  
LONDON SW7 1EZ  
SALES | +44 (0)20 7581 8277  
LETTINGS | +44 (0)20 7590 1200  
info@nicolasvanpatrick.com  
www.nicolasvanpatrick.com